



CONNECTRIC  
SYSTEMS INC.

28-207 Edgeley Blvd., Concord, Ontario, L4K 4B5  
Ph: 905-669-0080 Fax: 905-669-0082  
www.connectric.com info@connectric.com

IMO

# *iView* HMI



HMI solutions *you can view*

# iView HMI

## See the difference

### Advanced HMI Controllers

- Huge range of features included as standard
- Array of communications ports inc. Ethernet
- IP66 rated for increased protection
- 65K colour touchscreen as standard



## iView HMI

IMO's new range of iView HMI's are available in five screen sizes 4.3", 7.0", 10.4", 12.1" and 15.0". The HMI range options include M Series models for medium range applications and H Series models with higher capability for demanding applications.

The new HMI's have high resolution 65K colour resistive touch LCD TFT screens operating on an ARM based Processor. The compact and well-designed bodies are packed with features. Communication and data logging is made easy by incorporating a number of ports; two USB, one Ethernet, three serial and a Micro SD up to 16GB. These features make it possible to connect to printers, keyboards or a mouse, and data storage on a Micro SD card or USB Hard Drive.

Rich in communication features, iView allows for remote connectivity via VNC server as well as Ethernet protocols (Modbus TCP/IP, BACnet/IP, Profinet/IP), and Serial protocols (including Modbus RTU, BACnet, Siemens MPI).

## Software - iView Developer

The included licensed programming software is an exceptionally easy to use integrated development tool, featuring solution-oriented screen objects, high-end vector graphics, Windows fonts for multi-language applications, recipes, alarms, data loggers and operation logging. Other functions include Trending, XY Graph, Alarm Monitoring and Time Scheduling.



## Hardware Features

The iView range of HMI's from IMO are incredibly powerful and feature full colour touch screens with sizes ranging from 4.3" to 15.0". Never before have so many features been included as standard in an HMI, making the iView one of the most advanced HMI controllers ever produced.

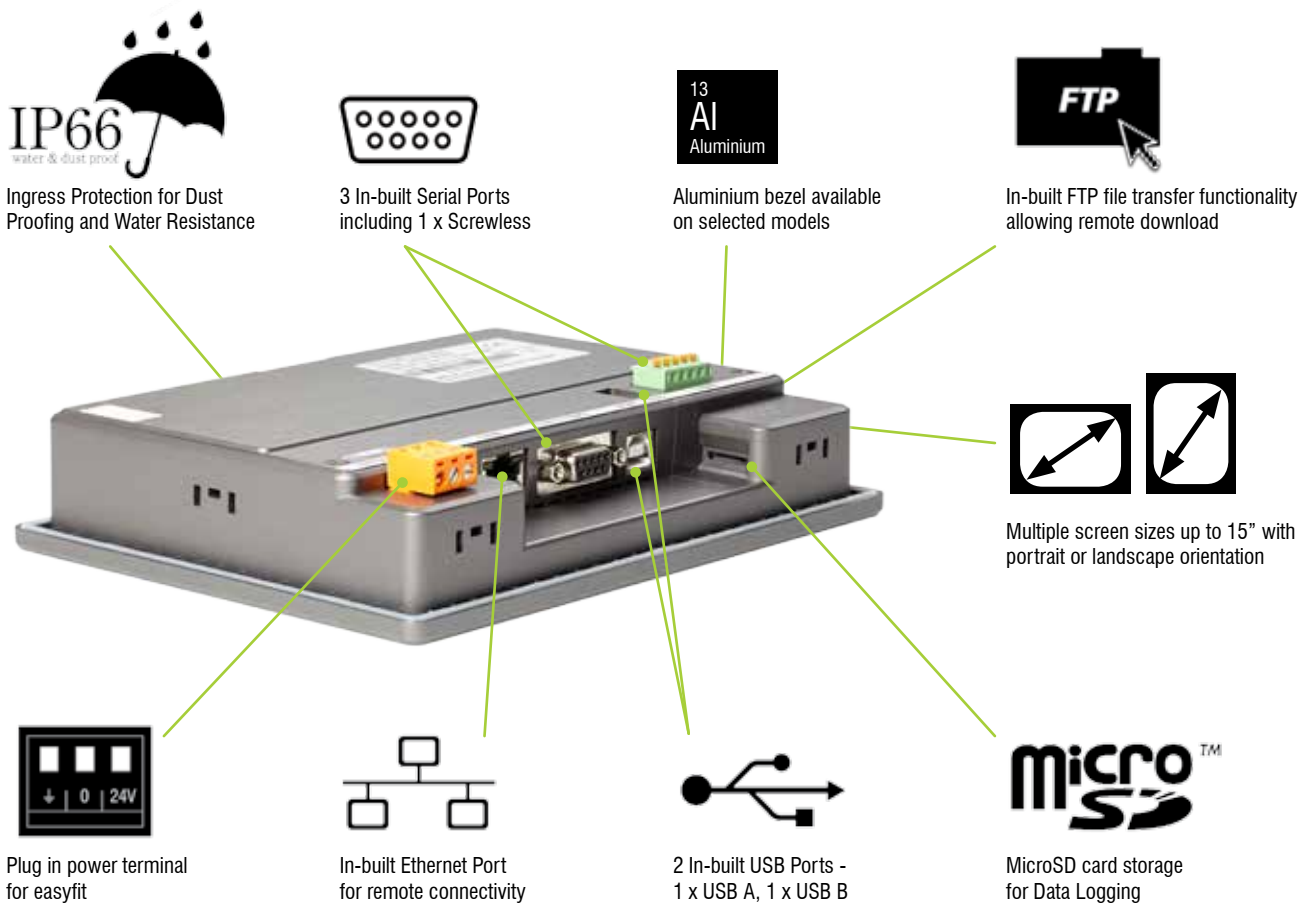

## Applications

The iView HMI has been optimised for implementation in the following areas and many more...



- Packaging Machinery
- Food Processing
- Water & Waste Treatment
- Custom OEM Products
- Motion Control
- Pump Control



- Custodial Vehicle Management
- HVAC & Environmental Control
- Communications Hub
- Dedicated Alarm Systems
- Building Management
- Process Control

# Communications Features

## Web Communications (VNC Server)

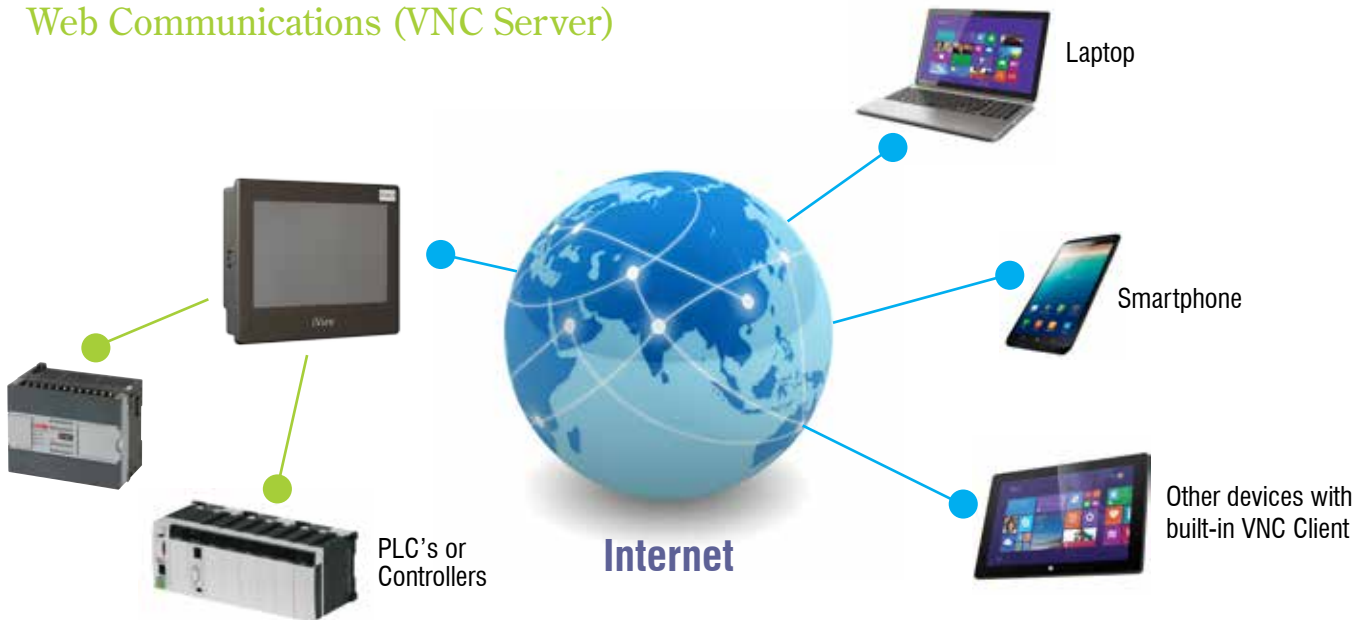

## Direct Link Communications

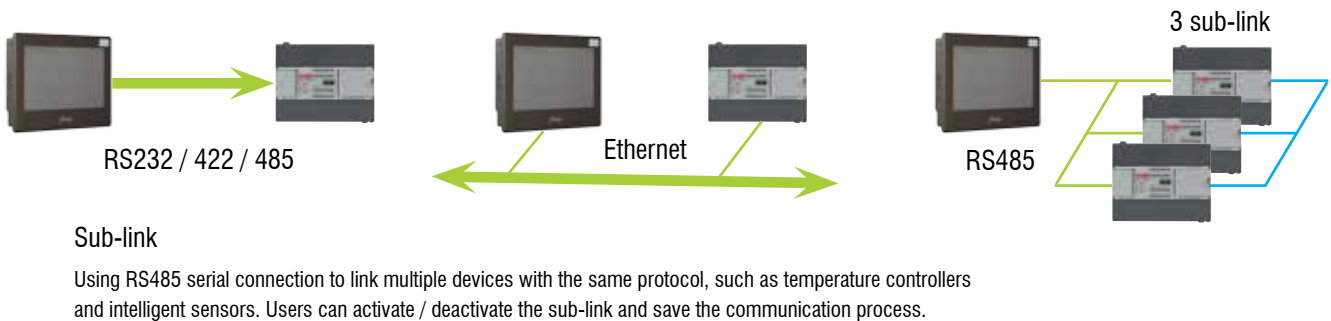

## Gateway Service

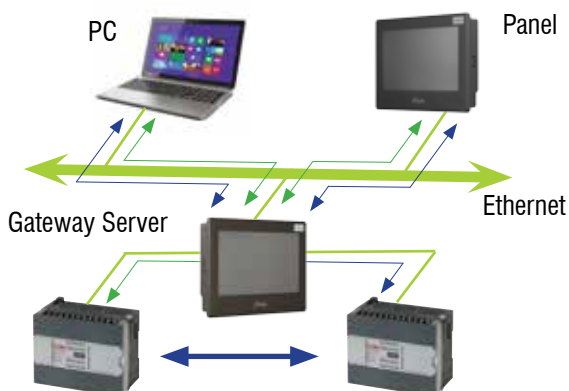

## N to 1 Communication Connection

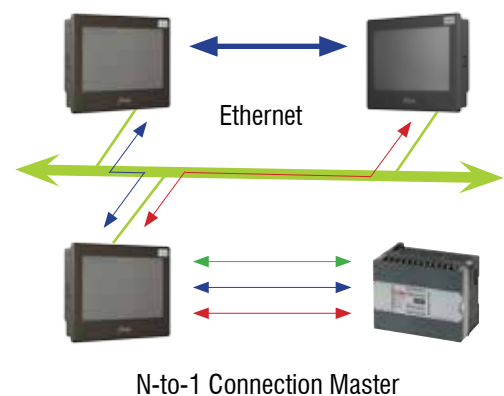



## Software Features - iView Developer

- Dynamic multi-lingual user interface with Unicode, offering screen text support for multiple languages
- All designs, macros and upload/download operations can be protected by passwords
- In-built serial port, Ethernet, USB and MicroSD card allows for downloading of runtime data
- User configurable script for improved functionality
- Comprehensive index registers are included for modifying device addresses in runtime
- Review and investigate important events using the Operation Log
- Supports over 380 industrial communication protocols inc. Modbus, BACnet MSTP/BACnet IP for 3rd party device communication
- Offline simulator to enable testing of the program before downloading to the iView



### Configurable Toolbars

#### *Icon Display Improves Work Efficiency*

Shortcut icons designed to show objects, figure type, and operations improving work efficiency

Frequently used objects and figures can be registered as favourites

### Dialog Box

*The property dialog is displayed by double-clicking the object or figure*

Figure changes are immediately reflected on screen, thereby simplifying the process and reducing errors

### Screen Design Worksheet

#### *Smart Screen Design*

Easy-to-view screens during runtime development, adjustable based on user-oriented application

### Project Workspace

#### *Intuitive Tree Display Makes Runtime Development Easy*

Easy to create, develop, and manage project property efficiency by project-based management worksheets

### Intuitive Error Messaging

#### *Compile & Simulate Results*

By double-clicking on the error message after compilation, it will jump to the specific place where the error is located

## Product Specification - M Series

Ordering Codes	IV04M-SEAP	IV07M-SEAP	IV10M-SEAP	IV12M-SEAA	IV15M-SEAA
Size	4.3" (16:9)	7.0" (16:9)	10.4" (16:9)	12.1" (16:9)	15.0" (16:9)
Resolution	480 x 272	800 x 480	800 x 600	800 x 600	1024 x 768
Colours	65k	65k	65k	65k	65k
System Memory	8 MB	8 MB	8 MB	8 MB	8 MB
In-built Storage Memory	128 MB	128 MB	128 MB	128 MB	128 MB
Battery Backup Memory	128 KB	128 KB	128 KB	128 KB	128 KB
COM1	RS232/422/485	RS232/422/485	RS232/422/485	RS232/422/485	RS232/422/485
COM2	RS232/485	RS232/485	RS232/485	RS232/485	RS232/485
COM3	RS232	RS232	RS232	RS232	RS232
USB	2	2	2	2	2
Ethernet	1	1	1	1	1
Real-Time Clock	Yes	Yes	Yes	Yes	Yes
Micro SD Slot	Up to 16GB	Up to 16GB	Up to 16GB	Up to 16GB	Up to 16GB
Certification	CE, UL, cUL	CE, UL, cUL	CE, UL, cUL	CE*	CE, UL, cUL
Ratings	IP66	IP66	IP66	IP66	IP66
Voltage Ratings	24VDC $\pm$ 10% Isolated	24VDC $\pm$ 10% Isolated	24VDC $\pm$ 10% Isolated	24VDC $\pm$ 10% Isolated	24VDC $\pm$ 10% Isolated
Power Ratings	10 W	20 W	20 W	20 W	20 W
Operating Temperature	-10°C to +60°C	-10°C to +60°C	-10°C to +60°C	-10°C to +60°C	-10°C to +60°C
Net Weight	0.35kg	0.6kg	1.2kg	1.9kg	2.68kg
Bezel Material	Plastic	Plastic	Plastic	Aluminium	Aluminium
Cut-out	119 x 93mm	175 x 132.5mm	260 x 202mm	301.5 x 228mm	385 x 283mm

\*IV12M-SEAA - Pending UL, cUL approvals



## Product Specification - H Series

Ordering Codes	IV07H-SEAA	IV10H-SEAA	IV12H-SEAA	IV15H-SEAA
Size	7.0" (16:9)	10.4" (16:9)	12.1" (16:9)	15.0" (16:9)
Resolution	800 x 480	800 x 600	1024 x 768	1024 x 768
Colours	65k	65k	65k	65k
System Memory	256 MB	256 MB	256 MB	256 MB
In-built Storage Memory	1024 MB	1024 MB	1024 MB	1024 MB
Battery Backup Memory	1 MB	1 MB	1 MB	1 MB
COM1	RS232/422/485	RS232/422/485	RS232/422/485	RS232/422/485
COM2	RS232/485	RS232/485	RS232/485	RS232/485
COM3	RS232	RS232	RS232	RS232
USB	2	2	2	2
Ethernet	1	1	1	1
Real-Time Clock	Yes	Yes	Yes	Yes
Micro SD Slot	Up to 16GB	Up to 16GB	Up to 16GB	Up to 16GB
Audio / Video	Optional	Optional	Optional	Optional
Certification	CE, UL, cUL	CE, UL, cUL	CE, UL, cUL	CE, UL, cUL
Ratings	IP66	IP66	IP66	IP66
Voltage Ratings	24VDC $\pm$ 10% Isolated	24VDC $\pm$ 10% Isolated	24VDC $\pm$ 10% Isolated	24VDC $\pm$ 10% Isolated
Power Ratings	20 W	20 W	20 W	20 W
Operating Temperature	-20°C to +60°C	-20°C to +60°C	-20°C to +60°C	-20°C to +60°C
Net Weight	0.8kg	1.25kg	1.9kg	2.68kg
Bezel Material	Aluminium	Aluminium	Aluminium	Aluminium
Cut-out	192 x 139mm	260 x 202mm	302 x 228mm	385 x 283mm

## Product Accessories

Ordering Codes	Description
MSD-16GB	16GB MicroSD Card
IV-USB	USB Programming Cable
IVIEWSP4	Screen Protector for 4.3" iView
IVIEWSP7	Screen Protector for 7.0" iView
IVIEWSP10	Screen Protector for 10.4" iView
IVIEWSP12	Screen Protector for 12.1" iView
IVIEWSP15	Screen Protector for 15.0" iView



# XGB U



# Programmable Logic Controllers

- Dual Port Ethernet
- 1 Channel RS232 Port
- 1 Channel RS485 Port
- Integral Web Server & FTP
- Data Logging Function
- Integral USB Port
- 8 Channel High Speed Counter
- Integral Email & SMTP
- Versions available with Integral Analogue or Positioning Options



With so many included innovations, the XGB U sets new standards in ultimate PLC performance. Compatible with the existing expansion modules of the XGB range, and with a host of outstanding features, the XGB U will provide the utmost efficiency for your applications. The integral web server offers monitoring of PLC information and data through a web browser that includes basic PLC information, module information, diagnostics and flag monitoring, data log file download capability, O/S updating, ladder program updates and more.

With increased CPU processing speeds and increased program capacity, the XGB U is the future of programmable logic controllers.

## EtherCAT Positioning Module (XBF-PN08B)

Offers high speed backplane transmission through USB host function, and standard EtherCAT protocol, CoE (CANopen over EtherCAT) with 1ms communication cycle.

Other features include Max. 8 axes servo driver control, 2-8 axes linear interpolation, 2 axes circular interpolation, 3 axes helical interpolation, & 8 types of CAM data to control CAM.

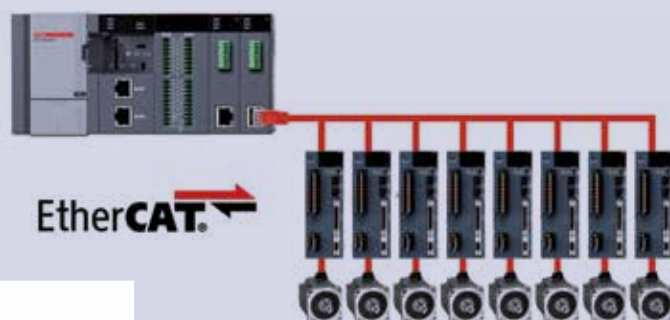

XGB U PLC Specification		
	XBC-U	XEC-U
Supply Voltage	230VAC/24VDC	230VAC/24VDC
Relay Output Rating	2A Resistive	2A Resistive
Transistor Output Rating	0.5A / point, 2A / COM	0.5A / point, 2A / COM
Program Capacity / Memory	32k steps	384kbytes
Max I/O Points	348/352* <sup>1</sup>	348/352* <sup>1</sup>
Analogue Input Resolution	1/16000* <sup>2</sup>	1/16000* <sup>2</sup>
Analogue Output Resolution	1/16000* <sup>2</sup>	1/16000* <sup>2</sup>
PID Control	Yes	Yes
Programming Languages	Ladder	IEC 61131
High Speed Inputs	8	8
Positioning	Yes	Yes

\*<sup>1</sup> Model dependant

\*<sup>2</sup> Applies only to models with analogue Input/Output

Product Selection			
	DI	RO (2A)	DO (0.2A)
XBC-DN(P)32U* <sup>3</sup>	16	-	16
XBC-DR28U	16	12	-
XBC-DN(P)32UA* <sup>3</sup>	16	-	16
XBC-DR28UA	16	12	-
XBC-DN(P)32UP* <sup>3</sup>	16	-	16
XBC-DR28UP	16	12	-

\*<sup>3</sup> N = NPN version P = PNP version  
For 24VDC models please add suffix "DC" to the part number



## Expansion Units & Accessories

	DI	Relay Out	DO	AI	AO	RTD	TC
XBE-DC08A	8	-	-	-	-	-	-
XBE-DC16A	16	-	-	-	-	-	-
XBE-DC32A*1	32	-	-	-	-	-	-
XBE-RY08A	-	8	-	-	-	-	-
XBE-RY16A	-	16	-	-	-	-	-
XBE-TN08A	-	-	8	-	-	-	-
XBE-TN16A	-	-	16	-	-	-	-
XBE-TN32A*1	-	-	32	-	-	-	-
XBE-TP08A	-	-	8	-	-	-	-
XBE-TP16A	-	-	16	-	-	-	-
XBE-TP32A*1	-	-	32	-	-	-	-
XBE-DR16A	8	8	-	-	-	-	-
XBF-AD04A	-	-	-	4	-	-	-
XBF-AD08A	-	-	-	8	-	-	-
XBF-AH04A	-	-	-	2	2	-	-
XBF-DV04A	-	-	-	-	4	-	-
XBF-DC04A	-	-	-	-	4	-	-
XBF-RD04A	-	-	-	-	-	4	-
XBF-TC04S	-	-	-	-	-	-	4
XBL-EMTA	Ethernet Communications Module						
XEL-BSSA	Modbus TCP I/O System						
PMC-310S	Serial Programming Cable						
USB-301A	USB Programming Cable						
XBC-XECBATTERY	Replacement Battery						
XB0-M1024A	Program EEPROM						
R40H/20HH-05S-XBM3	0.5m Cable link to breakout unit TG7-1H40S (XBM)						
C40HH-05SB-XBI	0.5m Cable link to breakout unit TG7-1H40S (XBE)						
C40HH-10SB-XBI	1m Cable link to breakout unit TG7-1H40S (XBE)						
TG7-1H40S	Screw I/O Termination (XBM & XBE)						

\*1 Please contact IMO in order to correctly specify the required breakout cable and terminal boards



▲  
C40HH-10SB-XBI  
Cable link to breakout unit



▲  
TG7-1H40S  
TG7GT Screw I/O Termination



▲  
XEL-BSSA  
Modbus TCP I/O System



▲  
XBL-EMTA  
Ethernet Comms Module



▲  
XBF-TC04S  
Expansion Module



▲  
XBF-AH04A  
Expansion Module



▲  
XBE-RY16A  
Expansion Module

- 
- The image displays four IMC iSmart modules. On the left is a small relay module with a single switch and a 'Run' indicator. To its right are three larger modules: a digital input module with a screen and a 4-way arrow keypad, a digital output module with a screen and a 4-way arrow keypad, and another relay module with a screen and a 4-way arrow keypad. All modules feature terminal blocks for wiring and are labeled with their respective functions and specifications.

## iSmart Base Units

PLC Type	AC Models	DC Models
Supply Voltage	85-264 or 19.6-28.8VAC	19.6-28.8V or 10.2-13.8VDC
Output Rating	8A Relay, 0.5A Transistor	
Timers	31 (Ladder) or 250 (FBD)	
Counters	31 (Ladder) or 250 (FBD)	
Analogue Input Resolution	N/A	12 bit (0.01V)
Analogue Output Resolution	N/A	12 bit (V, mA)
Function Keys (Not in blind version)	8	8
High Speed Inputs	None	2

## Product Specification

Part Number	Supply	DI	Relay Out	AI	Screen
SMT-EA-R10-V3	AC	6	4	-	Y
SMT-EA-R20-V3	AC	12	8	-	Y
SMT-ED-R12-V3	DC	8	4	2	Y
SMT-ED-R20-V3	DC	12	8	4	Y
SMT-ED12-R12-V3	12VDC	8	4	2	Y
SMT-BA-R10-V3	AC	6	4	-	N
SMT-BA-R20-V3	AC	12	8	-	N
SMT-BD-R12-V3	DC	8	4	2	N
SMT-BD-R20-V3	DC	12	8	4	N
SMT-CD-R20-V3	DC	12	8	4	Y

## Accessories

[illegible]

# iConnect

## Remote Machine2Machine Solution

- Connect automatically
- Manage devices
- Access log files remotely
- Built-in ethernet with 3G & 4G options

iConnect is a managed “connected black box” featuring built-in Ethernet and optional 3G or 4G modem. iConnect automatically connects to the IMOGateway, enabling you to run scripts, set up alerts, and access data for storage and analysis from IMO devices such as iCube integrated controller and iView HMI.

With iConnect you can setup a schedule to collect datalog files from your devices via FTP and synchronise onto your own servers or IMOGateway for analysis and alerts.

Security is at the forefront of the design and utilises the most current and adopted standards.



## It makes sense to switch to IMO

### We put more in, so you get more out...

- Wide range of products from Sensors to HMI's & PLC's
- The knowledge and experience to deliver the ultimate solutions
- Peace of mind with a 3 Year Warranty as standard



i<sup>3</sup> Intelligent Controller

PLC Starter Kit

Remote I/Os



Other IMO products available include Limit Switches, Temperature Controllers, Signal Conditioners, Photoelectric Sensors, Level Controllers and much more.